

ITEM NO.	PART NUMBER	DESCRIPTION	QTY.
1	10-10-7053	CONDENSER COIL-7053, TUBE AND FIN	1
2	10-40-7052	EVAPORATOR COIL 17.8 X 6 X 2.50, 4AC, 1H	1
3	12-10-3000	BINARY SWITCH—FEMALE 350/28	1
4	12-11-1001	BLOCK TXV 2 TON (EH)	1
5	12-40-1222	KALORI LOUVER, DIA 4.25" , HOLE DIA 3.95"	2
6	12-53-2003	RELAY-12V WP W/ RESISTOR	2
7	12-54-1001	THERMOSTAT-FIXED 24"	1
8	12-56-1005	MECHANICAL CONTROLLER, VISIONAIRE	1
9	12-59-7000	LIGHT, LED, 12V MAP LIGHT	1
10	13-10-1005	DRIER - 3030,3110,3115,3130	1
11	14-10-1250	CONDENSER FAN 12" 12VDC	1
12	14-20-0042	BLOWER 12 VDC	1
13	15-10-1022	FILTER, 12.5" X 3.50"	1
14	16-14-2661	#6 BULKHEAD STL	1
15	16-14-2662	#8 BULKHEAD STL	1
16	16-40-1102W	PRESSURIZER RING COVER-WHITE	2
17	16-92-1030	GROMMET, 3/8" ID FOR 5/8" HOLE	1
18	16-92-1070	TUBE GROMMET, IP67	2
19	16-92-1080	GROMMET, IP67, .02-.08 PANEL, .12-.20 CABLE	5
20	30-7052-001	HOUSING, UNIT	1
21	30-7052-002	MOUNTING BRACKET, ROOF TOP UNIT	1
22	30-7052-003	MOUNTING BRACKET, ROOF TOP UNIT	1
23	30-7052-004	COVER, ROOFTOP UNIT	1
24	30-7052-006	ADAPTER BRACKET, BLOWER	1
25	30-7053-001	BRACKET, CONDENSER UPPER SIDE, ROOF TOP UNIT	1
26	30-7053-002	BRACKET, CONDENSER LOWER SIDE, ROOF TOP UNIT	1
27	30-7053-005	COVER, ROOF TOP UNIT, 7053	1
28	30-7055-006	DRAIN PAN INSERT	1
29	30-7055-007	BLOWER BRACKET	2
30	32-7052-001	DRAIN PAN, ASSEM, ROOF TOP UNIT	1
31	32-7055-003-00	BEZEL ASSEMBLY, ABS	1
32	35-7052-004	SECONDARY LIQUID LINE, ADDITIONAL TUBE	1
33	35-7052-005	TUBE, SUCTION LINE	1
34	35-7052-006	DISCHARGE LINE, FIRST TUBE	1
35	35-7053-001	DISCHARGE LINE, SECOND TUBE	1
36	35-7053-002	PRIMARY LIQUID LINE	1
37	35-7053-003	SECONDARY LIQUID LINE	1
38	501-1-0-2	DRIER BRACKET	1
39	36-008-012ZSGSS	SELF-TAPING SCREW , #8, 1/2" LONG, FLANGED HEX HEAD , STAINLESS STEEL	2
40	36-010FWZP	BOLT, 1/4-20, 3/4" LONG, PHILL	27
41	36-010FWZP	FLAT WASHER, #10, ZINC-PLATED STEEL	17
42	36-014BLWSS	LOCK WASHER 1/4", BELLEVILLE SPRING, STAINLESS STEEL 18-8	17
43	36-014FWZP	FLAT WASHER, 1/4", ZINC, YELLOW CHROMATE-PLATED, STEEL	7
44	36-014CLNZP	1/4-20 LOCK NUT, WITH PLASTIC INSERT, ZINC PLATED, STEEL	5
45	36-014FWPP	FLAT WASHER , 1/4", PLASTIC, BLACK, OFF-WHITE	25
46	36-038FWZP	WASHER, FLAT, 3/8", ZINC PLATED	4
47	36-038LWZP	WASHER, LOCK, 3/8", ZINC PLATED	4
48	36-010C034MPPZP	BOLT, #10-32, 3/4" LONG, PHILL, SS	8
49	36-014LWZP	LOCK WASHER, 1/4", ZINC, YELLOW CHROMATE-PLATED, STEEL	4
50	36-038C100MBHG5	BOLT, 3/8"-16 X 1.00" LONG, HEX HEAD, ZINC PLEATED, GRADE5	4
51	36-0000-480	#8 X 1/2 BLK SMS	2
52	16-91-1048	CLAMP, WORM GEAR 3.0"-3.5"	2

OPTIONAL WATER VALVE SUBASSEMBLIES OFFERED SEPARATELY:
 34-0000-006 : 12V, FLOW AWAY FROM CABLE, ACTUATOR & MANUAL WATER VALVE KIT, SEE 90-0000-014
 34-0000-007 : 12V, FLOW TO CABLE, ACTUATOR, MANUAL WATER VALVE KIT, SEE 90-0000-016

47-7053-1190: 7053, ED, ACH, 12V

REVISIONS						
ECR	REV.	DESCRIPTION	DATE	DR.	AUTH.	CHK.
4143	0	INITIAL RELEASE	7/10/2023	MO	AS	MG

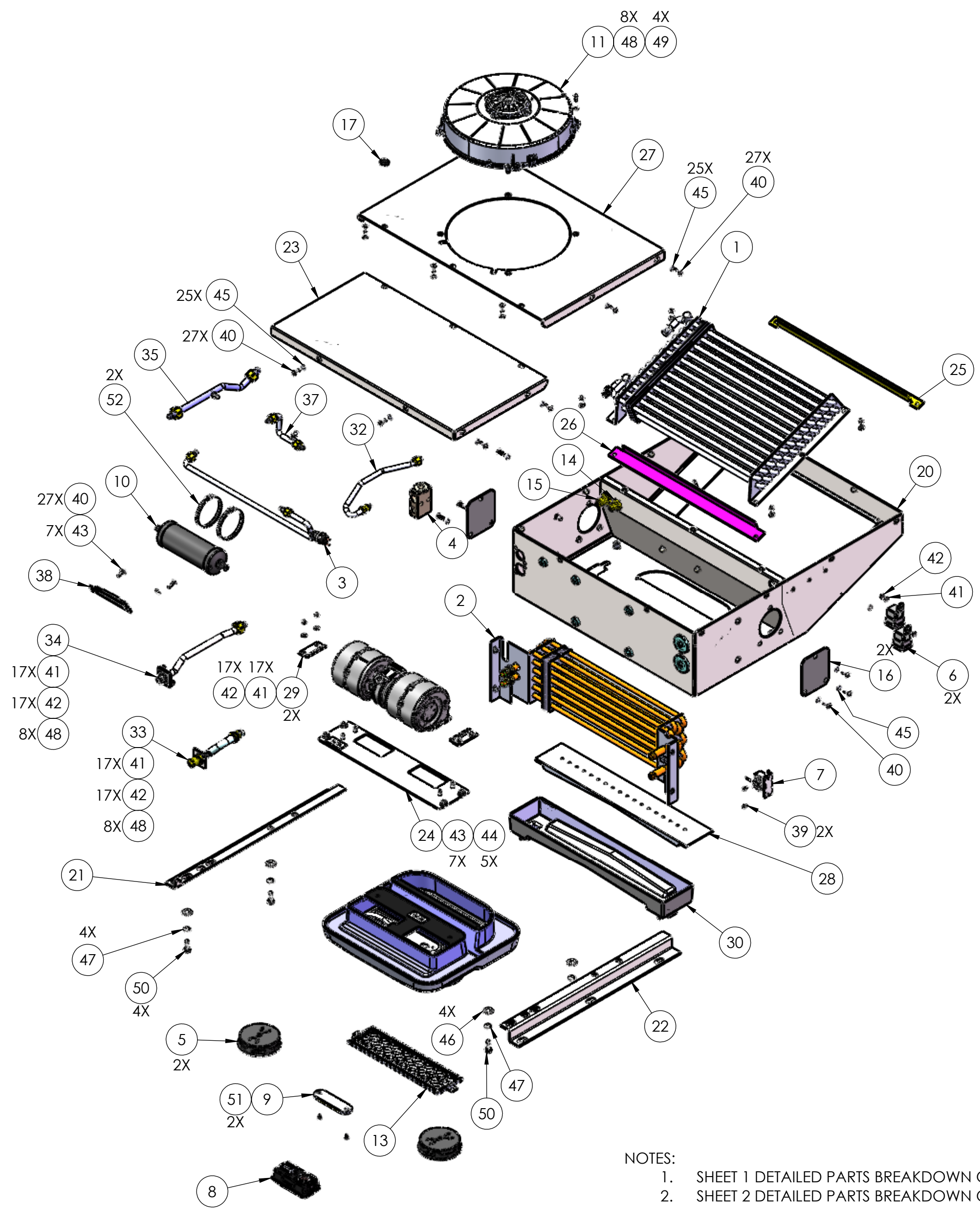

- NOTES:
 1. SHEET 1 DETAILED PARTS BREAKDOWN OF 47-7053-1190.
 2. SHEET 2 DETAILED PARTS BREAKDOWN OF 47-7053-2190.

IMPERIAL INCH FORMAT: UNLESS OTHERWISE SPECIFIED DIMENSIONS ARE IN INCHES WITH METRIC CONVERSION IN (MILLIMETERS)		INTERPRET GEOMETRIC TOLERANCING PER: ASME Y14.5-2009		VISIONAIRE, INC. 1401 VALLEY VIEW LN #135 IRVING, TX 75061	
UNLESS OTHERWISE SPECIFIED TOLERANCES ON: [.0]DEC [0.00]DEC DEC ANG ±.04 ±.020 ±XXX ±2°		DRAWN	MO	DATE	12/1/23
[0]DEC [0.00]DEC DEC [XXX] ±[1.0] ±[.5] ±[XXX]		CHECKED	MG	DATE	12/1/23
SURFACES [AA] [HOLE DIA] [HOLE SPACING] [HOLE LOC] ±.005 ±.015 ±.03 [±.13] [±.38] [±.8]		ENG APPR.	AS	DATE	12/1/23
DIMENSION IN (PARENTHESIS) ARE FOR INFORMATION ONLY. CRITICAL DIMENSIONS MARKED WITH [C]		THIRD ANGLE PROJECTION		TITLE: 7053, PARTS BREAKDOWN	
MATERIAL SEE NOTES DO NOT SCALE DRAWING		PROPRIETARY AND CONFIDENTIAL THE INFORMATION CONTAINED IN THIS DRAWING IS THE SOLE PROPERTY OF VISIONAIRE, INC. ANY REPRODUCTION IN PART OR AS A WHOLE WITHOUT THE WRITTEN PERMISSION OF VISIONAIRE, INC. IS PROHIBITED.		SIZE	DWG. NO. C 90-7053-004
				REV	0
		SCALE: 1:8		SHEET 1 OF 2	